

Dimensions

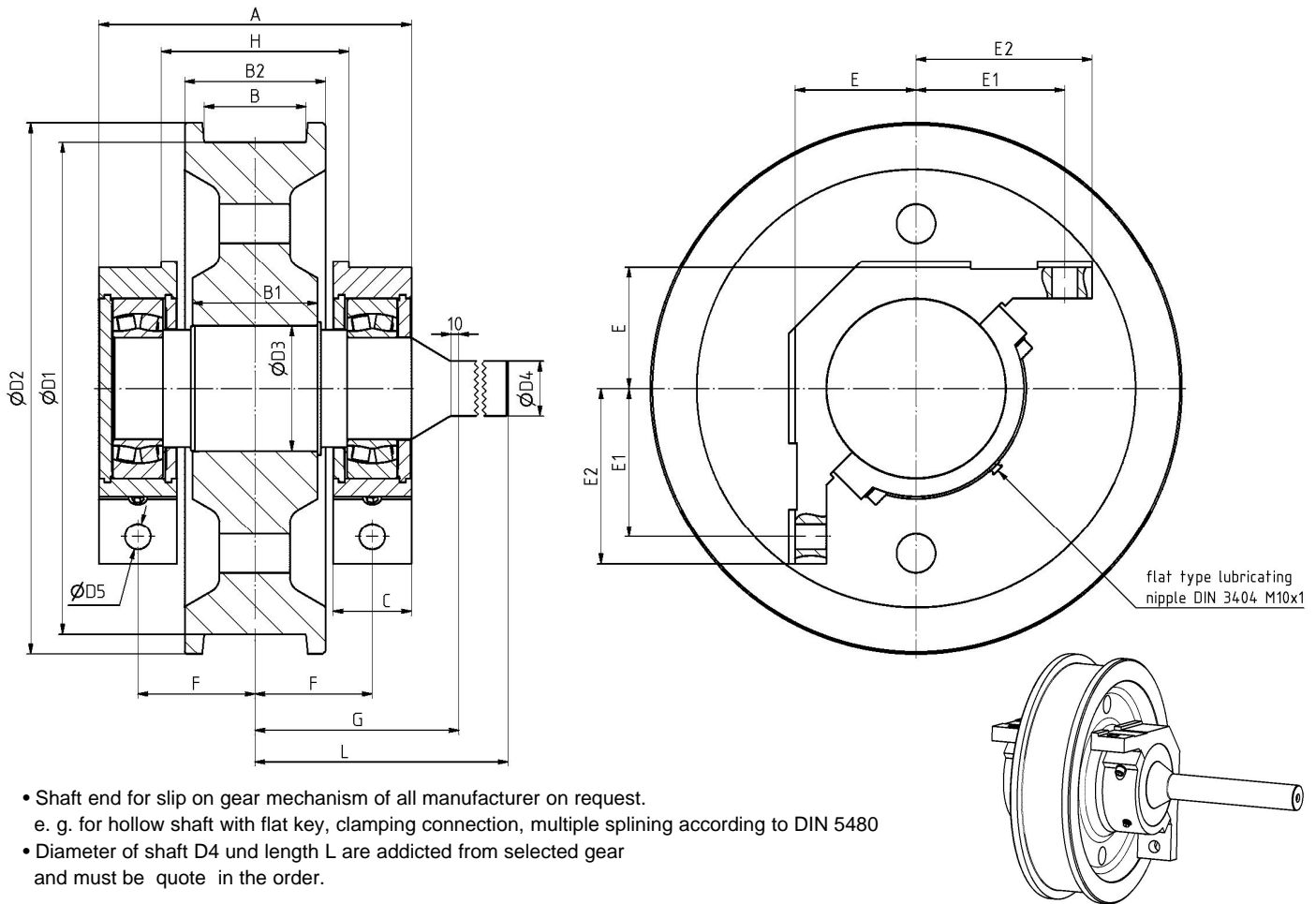

- Shaft end for slip on gear mechanism of all manufacturer on request.
e. g. for hollow shaft with flat key, clamping connection, multiple splining according to DIN 5480
- Diameter of shaft D4 und length L are addicted from selected gear and must be quote in the order.
- further particulars see non- driven wheel

D1	D2	D3	D5	B1	B2	G	A	H	F	C	E	E1	E2	B		bearing DIN 635	weight [kg]
														min	max		
315	350	110	23	110	130	225	330	185	120	90	120	135	160	50	90	223 16	160
400	440	120	23	140	160	235	330	205	125	80	125	145	170	60	120	222 20	220
500	540	130	27	140	160	235	345	210	130	85	140	160	190	60	120	222 22	300
630	680	160	33	160	180	260	400	240	150	100	155	190	225	70	130	222 26	480
710	760	170	33	210	210	270	435	265	165	105	165	200	235	70	160	222 28	730
800	850	180	33	210	210	295	469	285	175	120	180	210	245	70	160	222 30	900

All dimensions in mm
Weight is approximate declaration

Example of identification:

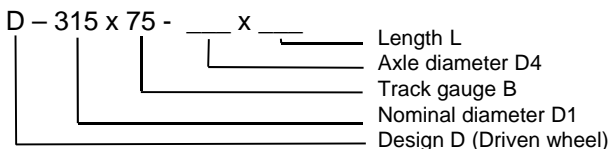

Available on request:

- allowed wheel pressure
- 2D- drawing
- 3D- model

Subject to change without notice